

# Resolução de problemas com o Drive DEEC

## Acesso via Web entra em LOOP

Se acontecer o acesso via browser entrar em LOOP e não conseguir aceder ao serviço, poderá utilizar as seguintes indicações para resolver o problema:

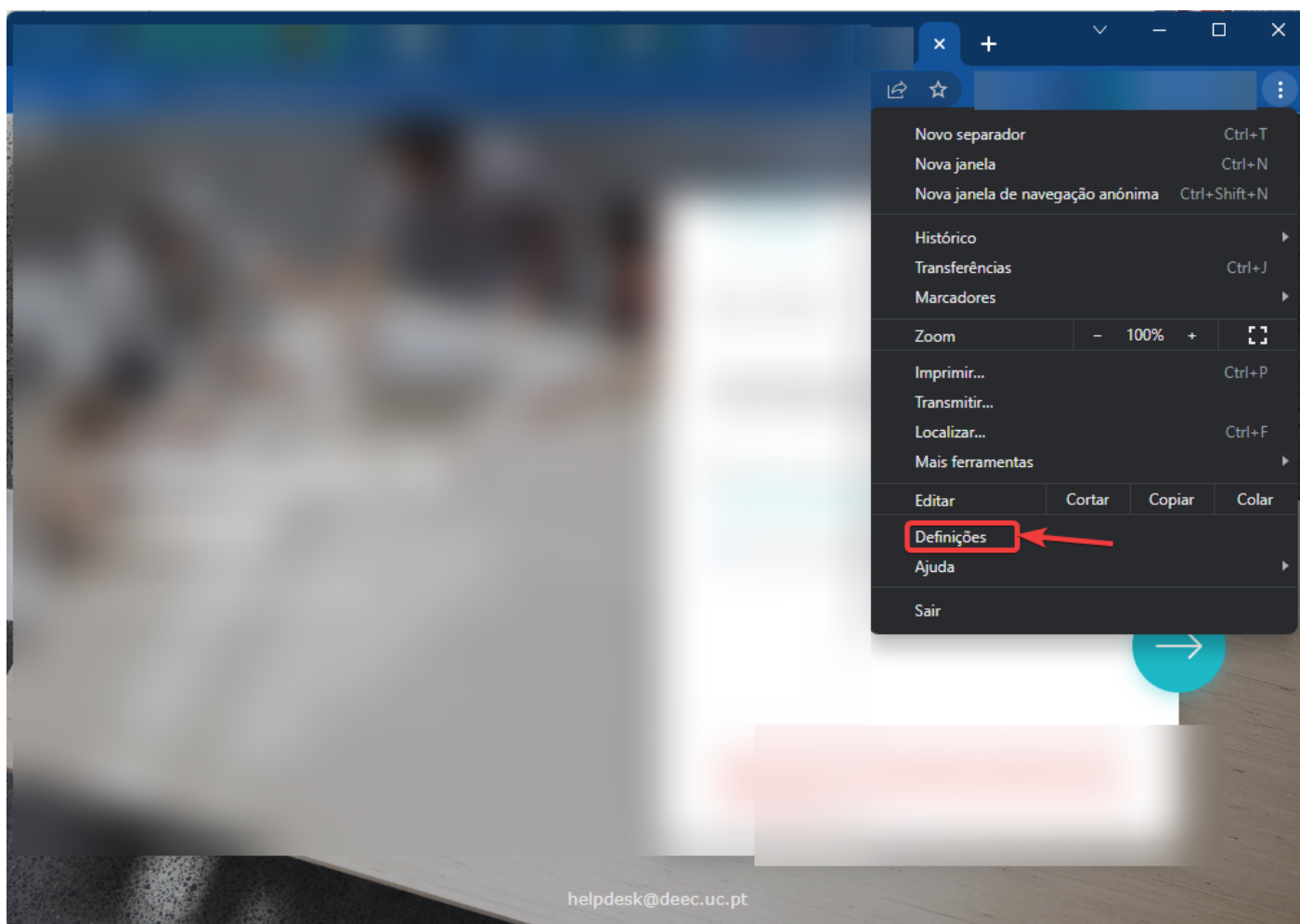

Pode, alternativamente introduzir o seguinte endereço na barra de URL:

<chrome://settings/content/siteDetails?site=https%3A%2F%2Fdrive.deec.uc.pt>

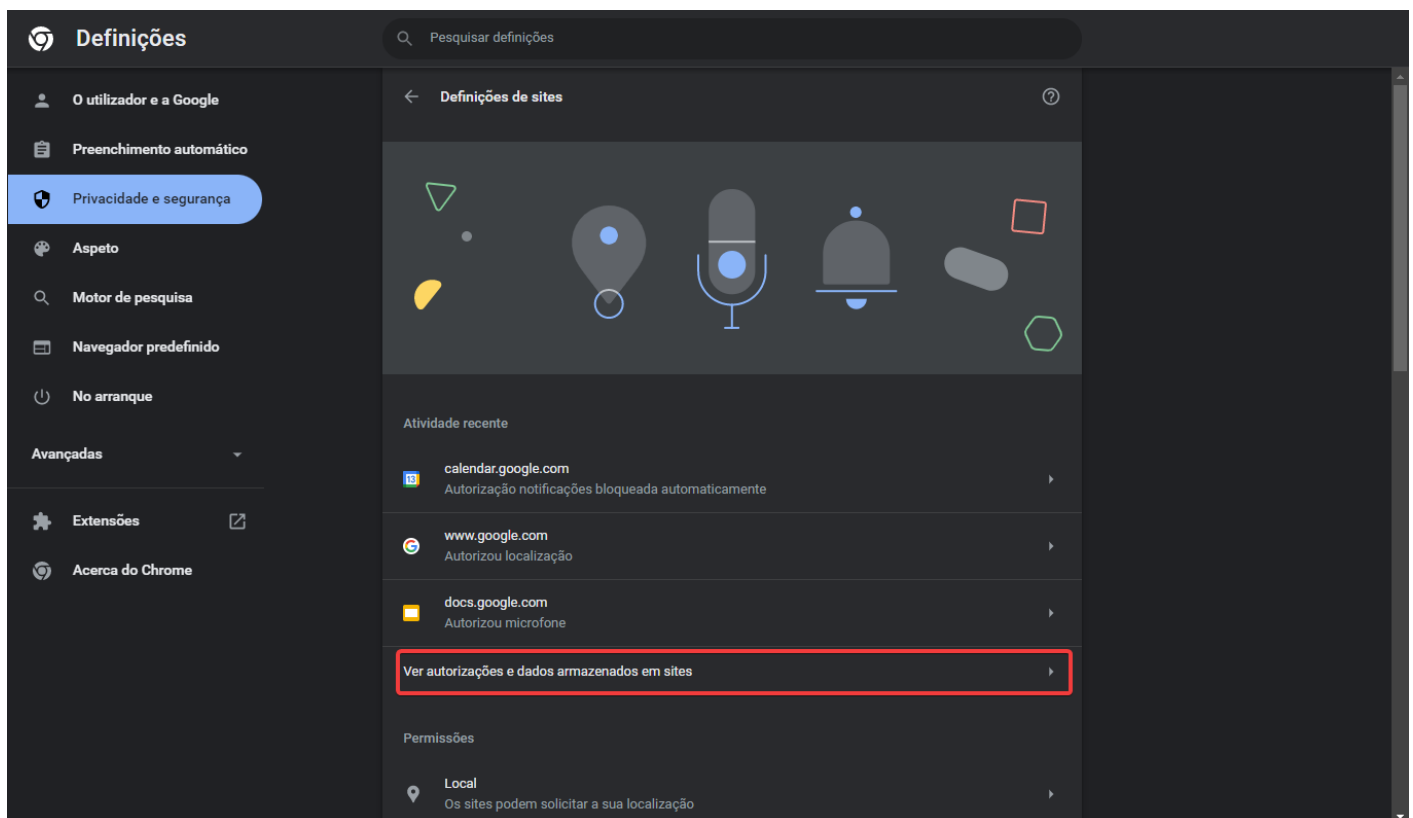
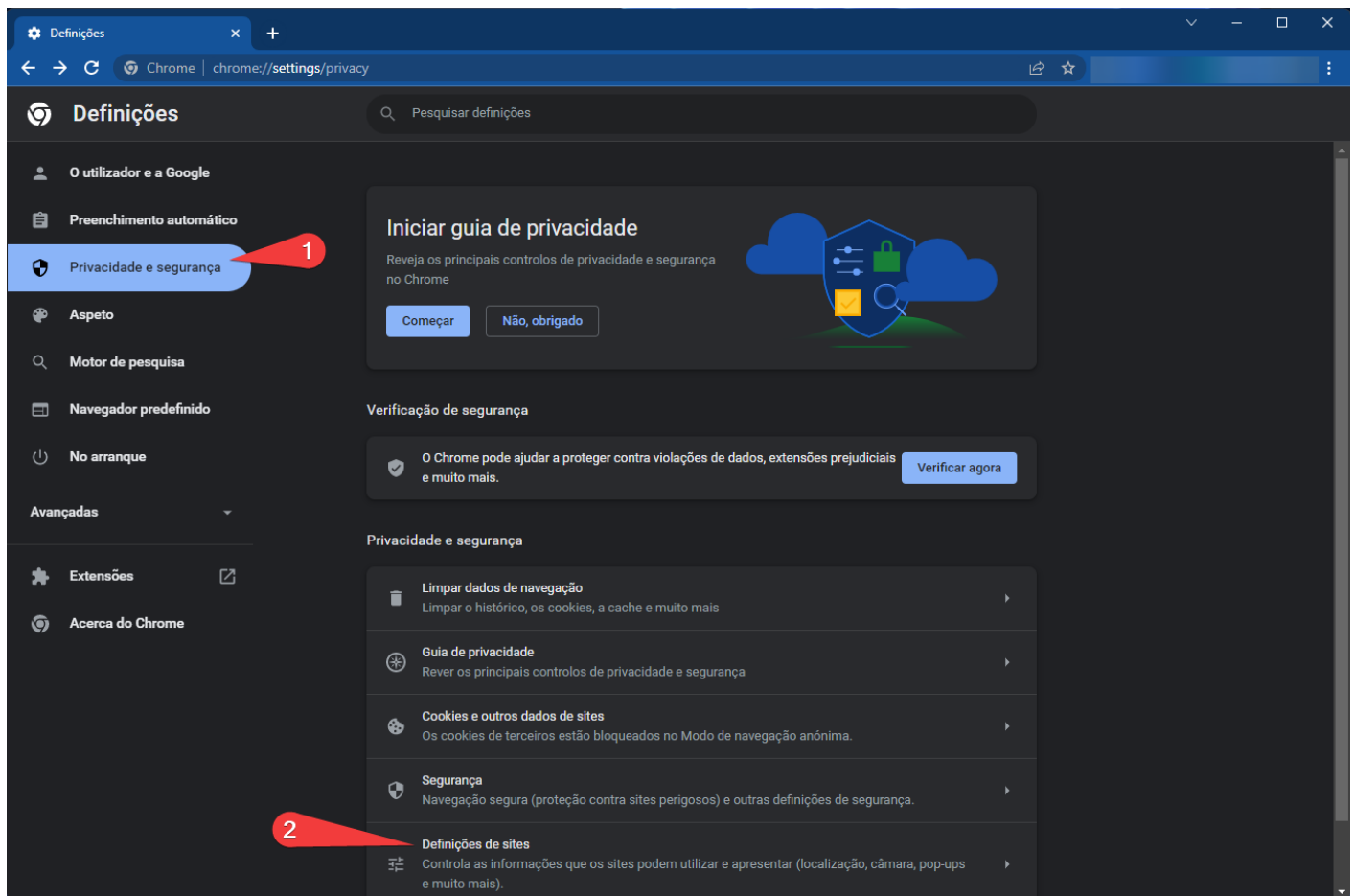

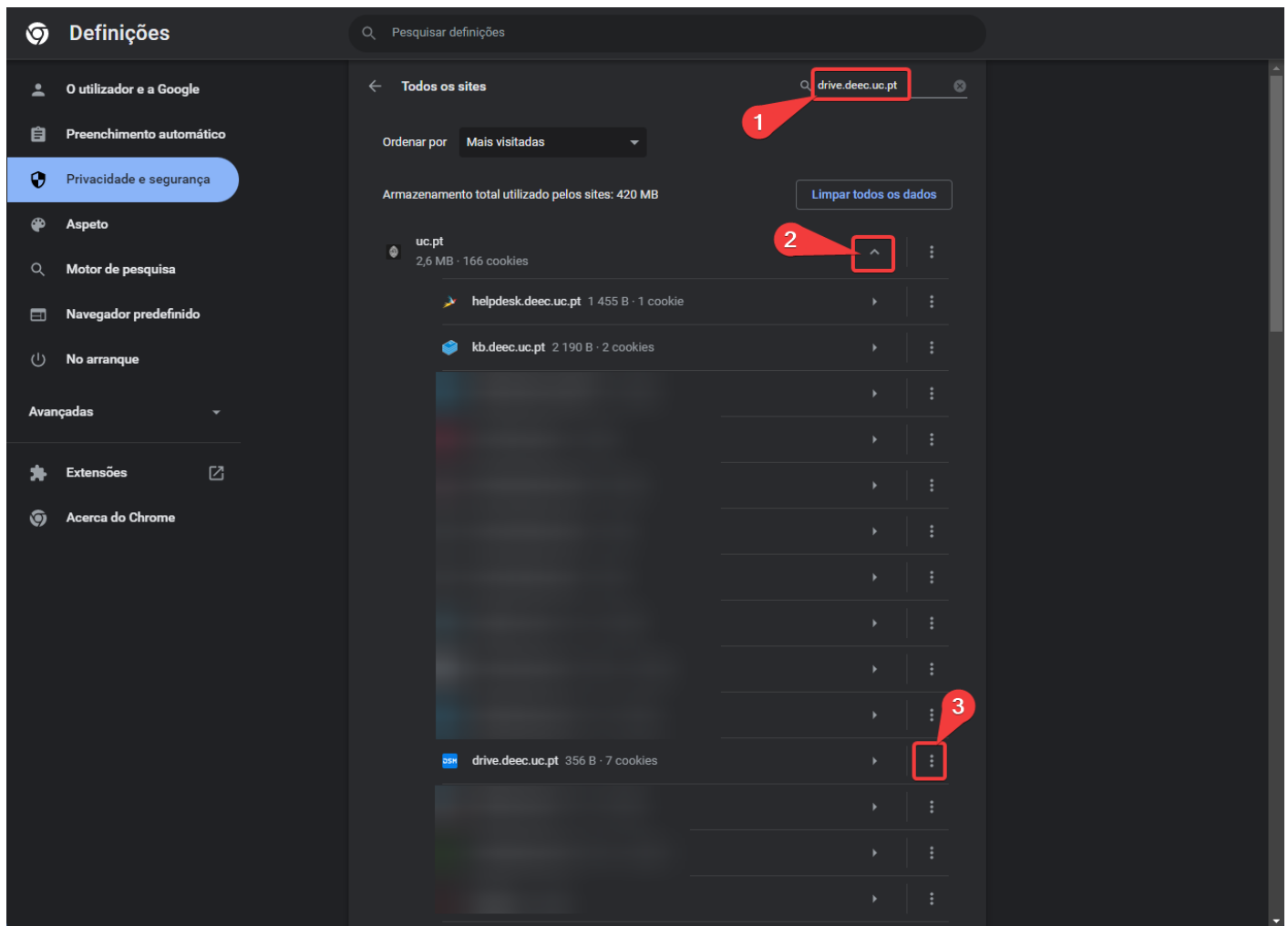

O problema deverá ficar resolvido.

Revision #1

Created 15 June 2022 14:05:06 by Francisco Maia

Updated 15 June 2022 14:15:53 by Francisco Maia